

# Irish Woodturners' Guild National Seminar

Radisson Blu Hotel, Limerick, Ireland  
Saturday 19 October & Sunday 20 October 2019

Seminar  
Programme



# LAGUNA

MAKING AWARD WINNING MACHINES SINCE 1983

AWARD WINNING  
14|12 BANDSAW  
REVO 18|16 LATHE  
P|FLUX

THE WORLDS MOST ADVANCED AIR CLEANING SOLUTIONS

**NOW IN STOCK!**



**vicmarc**<sup>®</sup>

WOODTURNING LATHES CHUCKS AND ACCESSORIES

## VL 300

SHORT AMS EVS LATHES

SHORT BED · ADJUSTABLE STAND MOUNT

ELECTRONIC VARIABLE SPEED

**CALL US FOR MORE INFORMATION**



**vicmarc**<sup>®</sup>

WOODTURNING LATHES CHUCKS AND ACCESSORIES

## IRELAND'S ONLY STOCKIST OF VICMARC CHUCKS

**CALL US FOR MORE INFORMATION**



COME VISIT OUR SHOWROOM IN THURLES

**MyTools**  
Quality Tools Online

**RONAYNE**  
TOOL & MACHINERY

JOHN J. RONAYNE LIMITED, DUBLIN ROAD, THURLES, CO. TIPPERARY  
t: 0504 21033 | e: ken@ronayne.ie | w: www.mytools.ie

# Welcome

Dear Delegate,

On behalf of the Executive Committee of the Irish Woodturner's Guild, I would like to welcome you all, delegates, demonstrators, guests and trade stand holders to this our 36th annual seminar.

It is great to be back here in Limerick in this lovely venue. It's wonderful to see old faces and new from home and abroad. Our generous sponsors as ever are on board with us again this year. Please support them with your custom. There is a great array of products.

We hope that we have provided an interesting and stimulating seminar with our choice of demonstrators and that there will be something for everyone. Please feel free to come to any committee member should we be able to assist you in any way.

As chairman, I would like to express my gratitude to my fellow committee members for their work during the year and especially in planning this weekend. Please let us spare a thought for members and friends who have passed away since last year and those who may be ill and unable to attend this year.

Finally, we hope you enjoy the weekend, get home safely home and come back and join us in Killarney in 2020.

Slan agus beannacht,



Willie Creighton  
Chairman, Irish Woodturners' Guild

## Chapter Challenge

This year the Chapter Challenge is crane used for lifting. The Limerick and District Chapter are again likely to present stiff competition following their hatrick of wins from 2016 - 2018. The winning chapter will receive the trophy and 2 free memberships.

The rules for this year's Chapter Challenge are:

1. All entrants **MUST** have their entry at the hotel before 5pm on Friday 18th as judging will begin at 5pm until 7.30pm by the six main demonstrators and on Saturday if required. This is required to give time to judge the efforts put in by the chapter woodturners.
2. The chapter challenge will take place at the 2019 National Seminar and is open to all chapters of the IWG. Each chapter is entitled and encouraged to submit one entry with pieces contributed from as many chapter members as possible.
3. The maximum display area for each chapter is
  - i. Base Maximum is 1 metre square,
  - ii. Height Maximum is 1.75 metres from Hotel floor and
  - iii. Jib or Arm or boom must be in proportion and Maximum space it can take up is 1.75 metres in total..
4. The crane should be a working model. This means that it should move and spin freely as real crane would. It does not have to be powered. If powered the max. Voltage is 12 Volts via a transformer or battery. Any entry higher than 12 Volts will strictly not be allowed to enter the competition, Additional related items such as lights are welcome.
5. The crane can be made from any materials available but judging will be done strictly on the turning of wood only and not on plastic, metal or acrylic turning.
6. There are no restrictions on the types of wood used. The use of woodturning techniques is encouraged and will be considered foremost by the judges over and above other disciplines such as woodcarving, lighting etc.
7. Chapters **MUST** submit a full list of materials used and include details of plans and techniques used... (This text should not contain any information that would identify the chapter or turners involved to the judges).
8. The competition co-ordinator will require a full list of participants. We would also appreciate photos of the participants and the project during development to be supplied.
9. The judges will select a winning entry from those that meet the criteria above based on their overall impression of the entries and woodturning. The Judges will supply a critique on all entries.
10. Above all, have fun and good luck!

# Information for Delegates

Every effort has been made to ensure that the information contained in this programme was correct at the time of going to press. Despite this, late changes may be necessary. Any corrections or alterations to the timetable or other information will be shown on a notice board.



**Delegates will be issued with lanyards which will have their name printed on them. Please wear the lanyard at all times. Persons without a lanyard will not be admitted to any of the demonstrations. Please return your Lanyard at the end of the event.**

## Safety:



Safety screens are in place in front of lathes in the demonstration rooms for the safety of all delegates. Cameras and video screens are also in place to provide a close up view. For the safety of all delegates, please do not encroach the demonstration area beyond the line marked on the floor at ANY time before, during, or after a demonstration.



If you have any concerns regarding safety during the seminar please bring them to the immediate attention of a member of the Executive Committee. Members of the IWG Executive Committee may be identified through their lanyards.



Please familiarise yourself with the location of the nearest fire exit within the hotel and conference centre. Should the fire alarm sound, please make your way through the nearest fire exit and to the appropriate assembly point. Do NOT return to any room until advised that it is safe to do so by the hotel staff.



Should first aid be necessary, please see a member of the hotel staff, or contact reception.

## Demonstrations:

We would request all delegates to be in the demonstration rooms on time to so as not to distract the demonstrator and detract from the enjoyment of other delegates.

If a demonstration room is full, please choose another demonstration.

Please ensure that your mobile phone is switched to silent or off during demonstrations.



Still photography of demonstrations is permitted, however please be considerate of the demonstrator and your fellow delegates when taking photographs so as not to disturb the demonstration. Flash photography during demonstrations is not permitted.



Video recording of demonstrations is not permitted unless you have the prior permission of the demonstrator. If permission is granted, please do not intrude on the demonstration or the enjoyment of other delegates.



Please **Do NOT Touch** any competition or chapter challenge pieces. This rule is in place to protect everyone and is essential to the success of our seminar competitions. Please observe the rule yourself and do not be afraid to enforce it or point out the “**Do NOT Touch**” signs if you see someone else about to break the rule.



Meals Entry into the Dining area is ONLY with a Delegate ID on a lanyard that you will be given at registration and the purchased ticket for that meal. **THE LANYARD MUST BE WORN AT ALL TIMES DURING MEAL TIMES.** Should you have any special dietary requirements, please notify the hotel reception in advance and they will attempt to facilitate you.



The free bus excursion for delegates partners and family will start at 9.00am sharp on Saturday 19th October. The first stop will be the Limerick Milk market. At around 10.30am the bus will depart to King John's Castle where you can enjoy the scenes and relax with a quick tea break until 1 or 1.30pm. The final stop is the heritage village of Adare. The bus will depart Adare at 4.30pm returning to the hotel around 5 or 5.30pm. *Note that lunch and refreshments are not included.*

# Donna Zils Banfield

Donna Zils Banfield has been creating works of art in wood since she received her first lathe as a surprise Christmas gift from her husband in 2001. Donna's skills on the lathe were self-taught but honed through workshops taught by gifted and skilled artists and turners who shared their knowledge. Her carving techniques and designs evolved after studying under several internationally recognised fine art and craft masters.

A teacher of woodturning since 2007 at Rockler Woodworking and Woodcraft, she now offers private one-on-one instruction in her studio, in Derry, NH. She has shared her knowledge and techniques with woodturning clubs throughout the United States. Most recently, she demonstrated for the New England Woodturning Symposium; the AAW International Symposium in Portland, OR; Totally Turning in Saratoga Springs, NY and the Virginia Woodturning Symposium in 2018.

Donna has been a juried member of the League of New Hampshire Craftsmen (LNHC) since 2010 and currently serves as a Juror in wood, evaluating and critiquing applicants seeking admission to the League as a juried craftsperson. Her work can be found in private collections in Australia, India, Taiwan and across the U.S.

More examples of Donna's work can be found on her website, [www.livealifelessordinary.com](http://www.livealifelessordinary.com)



## Donna's Demonstrations

*All of the techniques in these demonstrations are used in the creation of my series, "Illusions in Wood." The idea behind this body of work was initially inspired by Harvey Meyer's Baskets of Illusion series. Harvey had turned a large green cherry bowl to final thickness, and allowed it to warp as it dried. This creation truly deceived the viewer into believing that it was a woven basket, and the slouch, or warping completed the illusion. I was inspired to create an entire body of work that would deceive the viewer into believing it was something that it was not. It could be ceramic, pottery, glass or metal – until they picked it up to discover the deception.*



### Form is Everything

This demonstration will involve woodturning one or two of the forms that I use in my Illusions in Wood series. They may include a plate turned green to final thickness/thinness, an end-grain vessel, or a thick vessel with a shallow bowl in the center, sometimes referred to as a Saturn Bowl.

### Burn and Carve Patterns and Texture

This demonstration will explore: Types of wood to use for best illusions; Safety tips in selecting and using a Woodburning Unit and pens/tips; Selecting and using powered and hand carving gouges; Using these tools to create your patterns and textures on turnings or flat work.

### Completing the Illusion with Colour

This demonstration will complete the "illusion" by applying a variety of materials over the pyro-engraved surfaces. The illusion will be completed, creating what may appear to be pottery, ceramics, metal or woven basketry.

# David Lowe



David Lowe is a member of the Register of Professional Turners and is based in the small village of Snainton, situated at the foot of the North Yorkshire Moors National Park close to Scarborough.

David is also a member of the AWGB and has been turning for approximately 9 years. David's passion for working with wood is manifested in his use of traditional techniques combined with modern ideas such as air brushing texturing and piercing.

## David's Demonstrations

### Balancing Bowl on a Stand

Here we have a balance bowl made from Sycamore seeming to defy the laws of gravity, the stand is cut on a bandsaw and once sanded, finished with ebonising lacquer. It is all held together with chrome headed screws.



### Ash Goblet with Decorated Bowl and Base

This is a goblet made from Ash, turned and then decorated by emptying the grain, ebonising and re-filling the grain using a metallic coloured wax.

### Off-centre Turned Tea-light Holder

This Sycamore tea-light holder is turned using just one off-centre adjustment. It is finished with a decorative splatter effect of colour to the off centre area.



# Pat Walsh

Pat Walsh lives in Skerries, Co Dublin and has recently retired. He is a member of the Dublin Chapter and has been turning for about 15 years. Pat has demonstrated regularly in all the various Dublin Chapters as well as the other east coast chapters.

*Pat says "I started woodturning just for something to do as I thought it might pass an hour or two of my spare time, however I was hooked the first time the gouge cut wood. I joined the IWG and have found many new friends and met some interesting people as a result".*

Pat is a hobby turner with a preference for faceplate work and sometimes uses simple colour, carving and texture on his work, but only if the result is that the finished piece is enhanced.



## Pat's Demonstrations

### Monochrome Patterned Bowl

A fun small bowl with a pattern from a "stencil"

### Platter

This is a plain platter, with no enhancement. Emphasis will be on form and finish, with a particular emphasis on the type of Rim.

### Turn a Sphere the John Malone Way

A stunningly simple way to turn a perfect sphere of any size from as small as a marble to as big as your lathe can take without the use of expensive jigs or special tools. This is the method devised and used by renowned Irish woodturner John Malone.



# Room Map

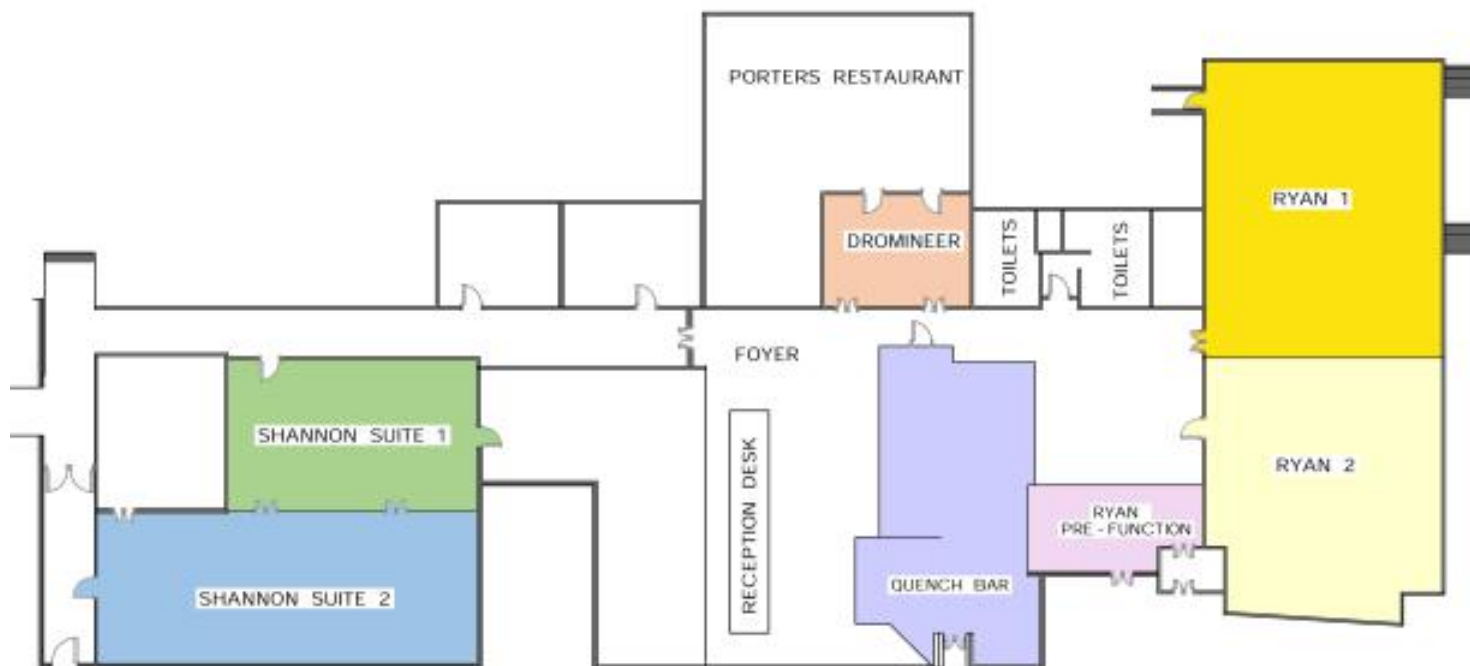

## Trade Stands

The Trade Stands are located in Ryan 1 and will be open at the following times:  
Saturday 8:00am to 7:00pm & Sunday 8:00am to 2:30pm

### The Carpentry Store

Noel Fay and Elaine Fay  
GMC Publications - Tony Kwasniak  
Robert Sorby - Clive Brooks  
Unit D4, M7 Business Park, Newhall, Naas, Co.Kildare.  
☎ 045 883 088  
✉ sales@thecarpentystore.com.  
www.thecarpentystore.com  
www.facebook.com/thecarpentystore

### Ronayne Tool & Machinery

John J Ronayne Limited, Dublin Road, Thurles, Co. Tipperary  
☎ 0504 21033  
✉ ken@ronayne.ie  
www.mytools.ie

### Hope Woodturning

Simon Hope  
2 Hall Cottages, Hall Rd, Great Bromley, Essex, CO7 7TR  
☎ +44(0) 120 623 0694 / +44(0) 774 781 7277  
✉ hopewoodturning@gmail.com  
www.hopewoodturning.co.uk

### Robert Sorby

Athol Road, Sheffield, S8 0PA. England  
☎ +44 114 225 0700  
✉ sales@robert-sorby.co.uk  
www.robert-sorby.co.uk

### The Wood Shed

Sam Moore and Lynda Moore  
11 Lowtown Road, Templepatrick, Co. Antrim. BT39 0HD.  
☎ 02894 433 833 (From UK)  
☎ 04894 433 833 (from Rol)  
✉ enquiries@wood-shed.com  
www.wood-shed.com

### The Hut

Des Harborne  
☎ 086 813 2040  
✉ dahut@live.ie  
www.thehutwoodturningsupplies.com

### Joe McKenna

Barry Lewis and Pat Roche  
54-56 Parnell Street, Limerick.  
☎ 0818 303 005 / 061 413 888  
✉ info@joemckenna.ie  
www.joemckenna.ie

### The Saw Doctor

Roland Flower  
Clough, Kenagh, Co Longford, N39 V184  
☎ 085 139 5457  
www.thesawdoctor.ie / www.logosol.ie

*Please support the trade stands.*



# Seminar Timetable

Saturday 19<sup>th</sup> October 2019

Room	Shannon 1	Shannon 2	Dromineer	Quench Bar / Reception	Ryan Pre Function	Ryan Suite 2
Time	Registration opens from 08:00. Competition area accepting entries in the Reception Foyer					
09:00	<b>Donna Banfield</b> Form is Everything	<b>Ivo Stoyanov</b> Lazy Susan Serving Platter with Lidded salt Holder	<b>David Lowe</b> A Balancing Bowl on a Stand	<b>Martin S Smith</b> The Importance of Great Finishing	<b>Eugene Grimley</b> Hollow Forms Made Simple	<b>Pat Walsh</b> Turn a Sphere the John Malone way
10:30	Morning Tea/Coffee in the Reception Foyer <u>Note</u> deadline for accepting competition entries is at 11:00					
11:00	<b>Donna Banfield</b> Burn and Carve Patterns and Texture	<b>Ivo Stoyanov</b> Traditional Bulgarian Drink Vessel	<b>David Lowe</b> Off-Centre Turned Tea Light Holder	<b>Martin S Smith</b> Atmosphere Colouring Using Waterbased Dyes	<b>Eugene Grimley</b> Two Tone Salt n' Pepper	<b>Pat Walsh</b> Platter. Emphasis on Form and Finish
12:30	Lunch will be served in the Porters Restaurant over two sessions at 12:35* and 13:15 * 12:35 Lunch seating will be for delegates with red label on lanyard Opportunity to visit Trade stands in the Ryan Suite 1					
14:30	Competition opens in the Reception Foyer (Please do not touch the exhibits – Even your own)					
14:30	<b>Pat Horgan</b> A Combined Earring and Ring Holder	<b>Ivo Stoyanov</b> Lidded Spice Holder	<b>Simon Hope</b> All Screwed Up Thread chasing	<b>Martin S Smith</b> Ring Box with Internal Finial	<b>Eugene Grimley</b> Square Lidded Box (Oriental Style)	<b>Pat Walsh</b> Monochrome Patterned Bowl
16:00	Afternoon Tea/Coffee in the Reception Foyer Last chance to vote for the People's Choice Competition in the Reception Foyer					
16:30	<b>Donna Banfield</b> Completing the Illusion with Color	<b>Pat Horgan</b> A Wine Coaster and Stopper	<b>David Lowe</b> Ash Goblet with Decorated Bowl and Base	<b>Eoin Barry</b> Off-Centre Swivel Clock	<b>Eugene Grimley</b> Hollow Forms Made Simple	<b>Pat Walsh</b> Turn a Sphere the John Malone way
18:00						
19:30	Gala Dinner in the Ryan Suite 2 - Speeches and Presentations Presentations to Competition Winners - Chapter Challenge Award					

Sunday 20<sup>th</sup> October 2019

Room	Shannon 1	Shannon 2	Dromineer	Quench Bar / Reception	Ryan Pre Function	Ryan Suite 2
Time	Registration opens from 08:00					
09:00	<b>Donna Banfield</b> Form is Everything	<b>Ivo Stoyanov</b> Lazy Susan Serving Platter with Lidded salt Holder	<b>David Lowe</b> A Balancing Bowl on a Stand	<b>Martin S Smith</b> The Importance of Great Finishing	<b>Eugene Grimley</b> Two Tone Salt n' Pepper	<b>Pat Walsh</b> Platter. Emphasis on Form and Finish
10:30	Morning Tea/Coffee in the Reception Foyer					
11:00	<b>Donna Banfield</b> Burn and Carve Patterns and Texture	<b>Ivo Stoyanov</b> Traditional Bulgarian Drink Vessel	<b>David Lowe</b> Ash Goblet with Decorated Bowl and Base	<b>Martin S Smith</b> Atmosphere Colouring Using Waterbased Dyes	<b>Eugene Grimley</b> Square Lidded Box (Oriental Style)	<b>Pat Walsh</b> Monochrome Patterned Bowl
12:30	Room Change – (No refreshments will be served)					
12:45	<b>Donna Banfield</b> Completing the Illusion with Color	<b>Ivo Stoyanov</b> Lidded Spice Holder	<b>David Lowe</b> Off-Centre Turned Tea Light Holder	<b>Martin S Smith</b> Ring Box with Internal Finial		
14:15						
14:30	Lunch in the Ryan Suite 2, followed by Seminar Raffle Draw 2019 Seminar Closes – Safe home and see you next year!					

# Eugene Grimley



Eugene Grimley is a retired Craft, Design & Technology teacher from Moy in Co. Tyrone. His woodturning career began in 2000 when he purchased a lathe and joined the Ulster Chapter of the Irish Woodturners' Guild.

Since Eugene's 'early' retirement in 2005, woodturning has become something of an addiction rather than a hobby. He does a lot of teaching and demonstrates in Ireland, Scotland and the north of England.

Eugene spends a great deal of time developing new demos, most of which contain a 'teaching' element. He served on the Executive Committee of the Irish Woodturners' Guild in various roles between 2005 and 2016.

## Eugene's Demonstrations

### Hollow forms made simple

Using only conventional tools, a small hollow form will be created in two parts and other uses of the technique will be displayed. The presentation will include discussion on the most suitable timbers and grain orientation for the project.



### Two tone Salt 'n' Pepper Shakers

Two different designs of salt and pepper shakers will be demonstrated. Both will use quite small pieces (offcuts) of wood and are ideal for using up those scraps we all have lying about.



### Square lidded box (Oriental Style)

Modern tools and equipment make the turning of square blanks more accessible to us all. The box is more decorative than practical and the finial is optional.



Ivo  
Stoyanov

Ivo Hristov Stoyanov lives and works in Gabrovo, Bulgaria. His grandfather, Donko Milchev Stoyanov, was one of the acknowledged masters of woodturning in the Gabrovo region. At a young age Ivo was attracted by the beauty of wood. He enjoyed the skillful work of the old master for hours and learnt perfectly to recognize the type of tree by the smell of the wood.

Later on, fate brought Ivo back to woodturning professionally, after his cousin Danail Krastev invited him to work together on the lathe making wine vessels at the Architectural and ethnographic complex "Etar". He quickly learnt to make all traditional articles from the register of the craft. Ivo enjoys mostly making wine vessels, the article that requires great skill and workmanship.

In 2004 Ivo joined the Regional Chamber of Crafts in Gabrovo. Although there are no secrets for him in the craft, he doesn't stop seeking the best combination of the natural colour of the wood, the form of the vessel and the carving upon it. As a challenge, Ivo is engaged in an on-going search for contemporary forms and application of the woodturner's tools that will continue to delight the visitors and guests of "Etar".

### Ivo's Demonstrations



Traditional Bulgarian Drinks Vessel



Lazy Susan Serving Platter with Lidded Salt Holder



Lidded Spice Holder Bowls

# Martin Saban-Smith

Martin Saban-Smith is a well known social media woodturner with an internationally known and respected YouTube channel with around 200 turning and business oriented videos on it. In October 2018, Martin was accepted onto the Register of Professional Turners.

Many of his pieces have colour applied to them, as well as other embellishments. Martin's own turning is more artistic rather than practical with many pieces having been filmed for his social media channels."

## Martin's Demonstrations



The Importance of Great Finishing



Atmosphere Colouring Using Waterbased Dyes

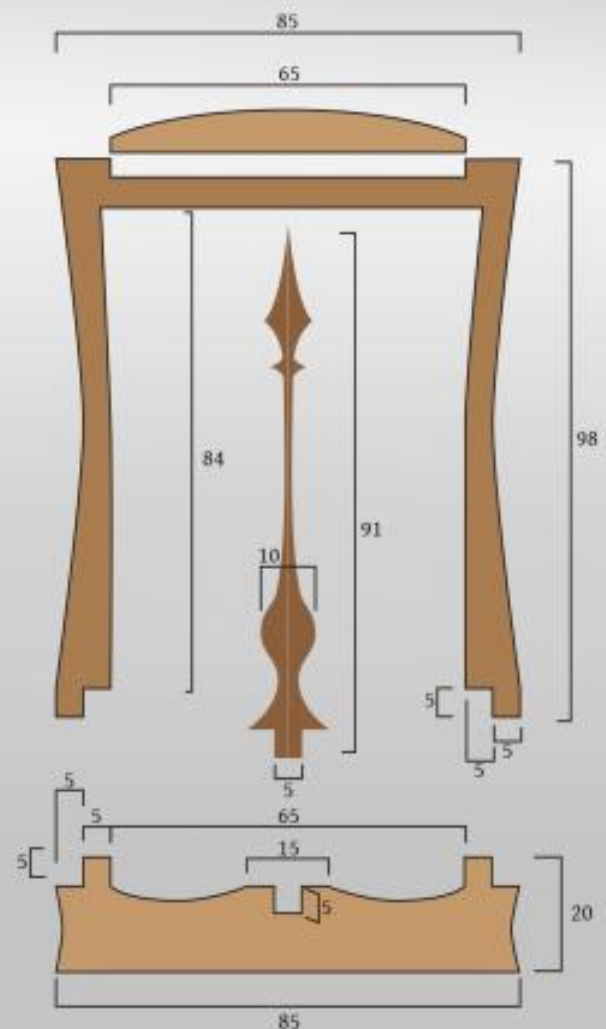

Ring Box with Internal Finial

## Pat's Demonstrations

### Combined Earring and Ring Holder

This involves both faceplate and spindle turning, the accurate drilling of various holes including off centre holes. The project may be made using two contrasting woods or painting/ebonising techniques.



### A Wine Coaster and Stopper

This features faceplate, spindle and off-centre turning. The holder for the stopper is designed to resemble the top of a wine bottle.



## Pat Horgan

Pat Horgan is a woodturner based in Ballina Co. Tipperary. He has been turning since 2008. He is a member of the Limerick and District chapter of the Irish Woodturning Guild. He has demonstrated for his local chapter on a number of occasions. He has completed master classes with Richard Raffan, Mike Mahoney, Ray Key, Glenn Lucas and Phil Irons. He particularly enjoys making bowls, platters, boxes and lidded bowls. He also enjoys the friendship of other woodturners and sharing knowledge with other woodturners.

## Simon Hope



Simon Hope has been woodturning from the age of 11 and at the age of 26, was the youngest to be on the register of professional turners. 18 years on, Simon has vast experience in demonstrating across the UK and Europe, including being a full presenter for the UK, Irish, German and Danish main seminars, as well as a year 3 stint as a tutor for La Mounlin in France. Simon specialises in artistic turnings and boxes with the use of silver and pewter as well as making Scottish small pipes. His pipes are played around the world. In recent years Simon has been designing and manufacturing woodturning tools and jigs.

### Simon's Demonstration

All screwed up. Thread chasing by mechanical means and hand.

## Eoin Barry

I am an electrician from Quin, Co. Clare. I have been turning on and off since I was in secondary school. I joined the Limerick and district chapter of the Irish Woodturners Guild in 2013 and have been completely addicted since.

I am interested in all aspects of woodturning and enjoy trying new techniques. I use mainly native green timber that I usually harvest myself locally whenever I get the opportunity.



### Eoin's Demonstration



An off centre swivel clock



the  
CARPENTRY  
store

Entry  
€5

## Woodwork, Hobby & Craft Fair 2019

Friday 8<sup>th</sup> November 10am - 6pm  
Saturday 9<sup>th</sup> November 10am - 5pm

### Demonstrations & Trade Stands



Come & meet **Andrew Hall, Deneb Puchalski, Vic Tesolin, Seamus Cassidy** and over 20 other demonstrators

Woodturning - Woodcarving - Pyrography - Hand Tools - Power Tools - Finishes - Hobby & Trade Machinery - Routing Clinics  
Everything you need for your Woodworking Projects.

Visit our website for updates & more details...

**[www.thecarpentrystore.com](http://www.thecarpentrystore.com)**

Unit D4, M7 Business Park, Naas, Co. Kildare 045 - 883088

# Seminar Competition Rules

- 1. The Competition will take place on Saturday 19th October 2019. All entries must be presented at the competition room by 11am. Failure to do so will lead to pieces not being accepted for the competition.**
- 2. Entries will be accepted from attendees at the seminar in one of three sections; Under 19, Non-Professional or Professional.**
  - A maximum of three entries per person will be accepted.**
  - Entries will not be accepted in more than one section.**
  - The Under 19 section will be subdivided into two categories U16 and U19. Entries will be accepted and placed in the appropriate category according to the participants age.**
  - The Non-Professional section will be subdivided into the following competition categories; Open, Novice, Spindle, Segmented and Artistic. A person may not enter more than two pieces in any one of the Non-Professional categories.**
  - It is up to the entrant to declare and define what competition section they are in. In the event of this leading to a complaint or query the IWG Executive Committee reserves the right to clarify and rule on the matter.**
  - It is the responsibility of all entrants to collect their items. The Executive Committee of the IWG will not be responsible for items not collected by 2:30pm on Sunday 20th October 2019.**
  - Pieces entered in previous IWG National Seminars must not be entered.**
- 3. In the event of work being delivered to the competition room without designation to a particular section/category the IWG reserves the right for the room steward to allocate the piece to a category.**
- 4. IWG members who are unable to attend are permitted to have their pieces submitted on their behalf for a fee of €10. This fee will not be applied to entries submitted in the under 19 section.**
- 5. Prizes will be awarded for each of the sections/categories as determined by the IWG Executive Committee In addition there will be an award for the overall winner and a "peoples' prize".**
- 6. While this competition is primarily a woodturning competition, the use of colour, texture, bone, plastics, metals and gilts is accepted as part of the competition. The use of Ivory is not permitted unless in a synthetic form for example sourced from nuts or plastics. The Lichtenberg/Fractal wood burning is banned by the IWG and pieces using this technique will not be accepted.**
- 7. Professional turners and demonstrators can only enter the Professional Section. As a broad guideline someone earning a significant proportion of their income from woodturning activities should consider himself or herself professional. Members of the RPT will be classed as a professional.**
- 8. The Executive Committee will select judges the competition.**
- 9. Anyone who may have a grievance with the competition may lodge this in writing with the Honorary secretary. Any grievance must be lodged within seven days of the competition.**
  - Any queries at the time of the competition should be brought to the attention of the chief competition steward who will, if necessary, advise the IWG Executive Committee.**
  - The IWG Executive Committee reserves the right to clarify or investigate any query or grievance with the individuals involved. Any query or grievance made by rumour or in an anonymous fashion will not be acted upon.**
  - The IWG Executive Committee will make every effort to resolve any issues in a friendly, equitable and confidential manner and will ensure there is no conflict of interests in dealing with matters relating to the above.**
  - No member of the IWG should approach a judge or judges with a grievance on any decision made by them. This may result in disqualification and possible exclusion from future competitions.**
  - Any member who expresses themselves in a threatening or abusive manner towards competition Organisers, Judges or Stewards will be disqualified and may be barred from future competitions.**
  - Decisions by the IWG Executive Committee on matters relating to the organisation and management of the IWG National Seminar Competition are final.**

# *Joe McKenna Hardware*

**TOP BRANDED TOOL SPECIALISTS  
IN THE HEART OF LIMERICK CITY**  
15 metres from bus and rail station



STOCKISTS OF NOVA GALAZI, LAGUNA, RECORD POWER &  
CHARNWOOD WOODTURNING LATHES AND ACCESSORIES.

## *Massive Two Day Sale*

### *6th & 7th December 2019*



*50% off full range of Stanley Hand Tools.*

Demonstrations and Expert Advice from  
Festool, Record Power, Trend Routing, Charnwood and Robert Sorby

## **Up to 50% Discount off all products across the store**

*Find us on Facebook and Instagram*



**54-56 Parnell Street, Limerick. Tel: 061 413 888**  
**e-mail: info@joemckenna.ie web: www.joemckenna.ie**